

STUDIO CENTRAL POWER UNIT - TS1 240V

The central power unit is equipped with **tangential inlet**, with **double dust inlet**, with **SOFT START** starting system, and with **washable polyester filter cartridge**.

Is provided with electronic control card compatible with CMT800 **Dynamic Control Display** and CM8890 **REMOTE panel**

Authentic beauty, functional design is equipped with **ergonomic handles** making it easier to open and unhook the dust container.



COMMERCIAL DATA

CODE	DESCRIPTION	CUSTOMS CODE	BAR CODE	PACKAGING BOX (cm.)	UNIT WEIGHT (kg)	PACKAGE Q.TY (n°)
CMTS1	STUDIO CENTRAL POWER UNIT - TS1 240V	85086000	 8 025219 033146	40x40x81	13,5	1
Q.TÀ x PALLET (n°)	15					

TECHNICAL DATA

STUDIO TS1 - CMTS1		UNITS			
Power supply	240	Volt (Vac)	Dynamic Control Display compatibility (CMT800)	YES	
Motor power	1.260	Watts (W)	Panel Remote compatibility (CMT8890)	YES	
Frequency	50/60	Hz	Wireless system compatibility (CM186)	YES	
Motor rpm	43.507	rpm	SOFT START starting system	YES	
Noise	dB	57	Right and left dust inlet	YES	
Turbine stages	1	n°	Right air exhaust	YES ¹	
Socket power supply	12	Volt (Vcc)	Silencer as standard equipment	NO	
Vacuum power	504	Air Watts	Recommended number of sockets	5	n°
Max. air flow rate	207	m ³ /h	Most distant socket	25	m
Max vacuum	270	mbar	Recommended surface	0 - 120	m ²
Filter cartridge surface	4.000	cm ²	Max area to be served	150	m ²
Filter cartridge material	POLYESTER				
Dust container capacity	15	litres			
Height	64	cm			
Diameter	28	cm			
Weight	13	kg			
¹ Convey for exhaust conveyor line (optional)					

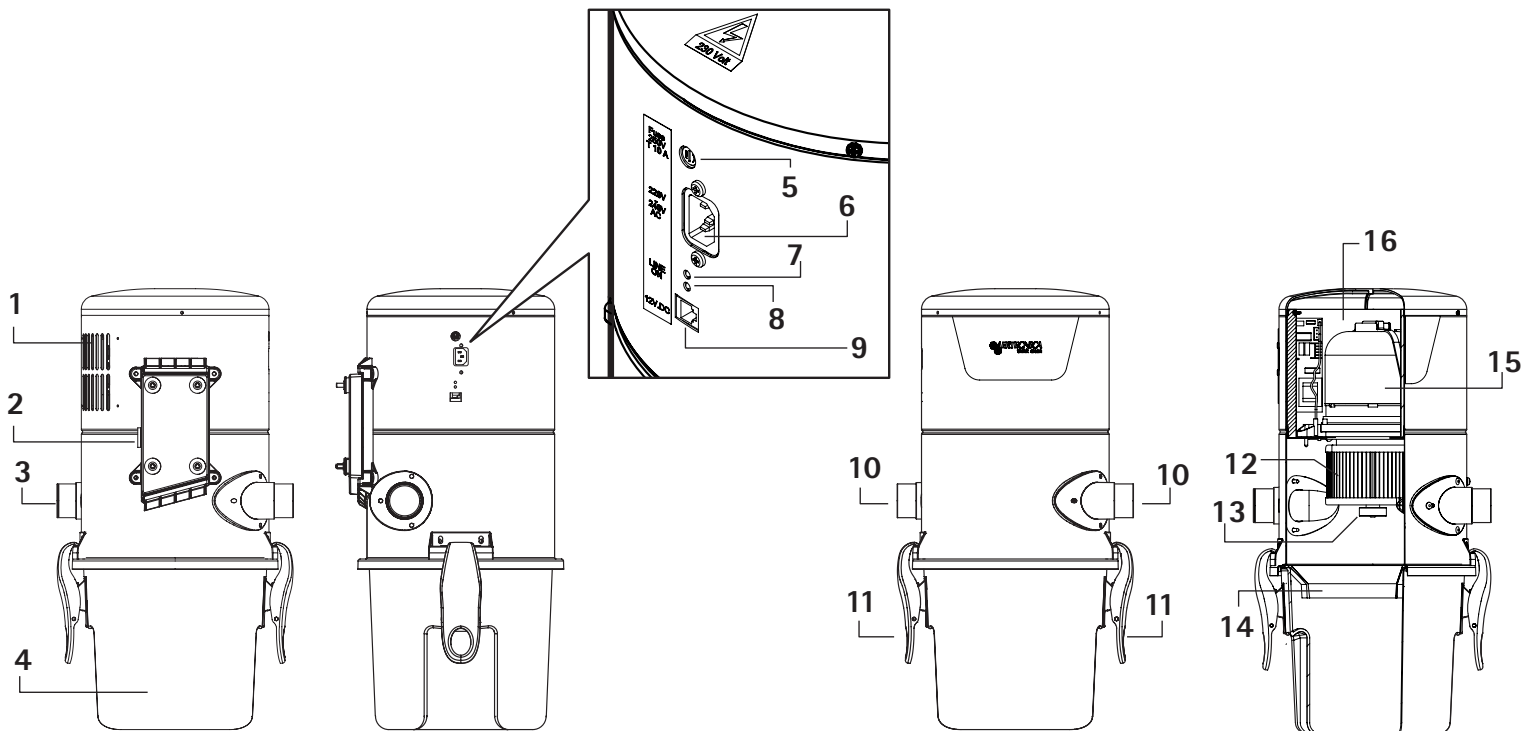

LEGEND

- | | | |
|----------------------------|--------------------------------------|----------------------------------|
| 1 - Motor air intake | 7 - Green Led On: power unit on | 12 - Filter cartridge |
| 2 - Locks lever | 8 - Green Led On: power unit running | 13 - Fixing bracket |
| 3 - Dust inlet closing cap | 9 - Operation Signal input | 14 - Cone conveyor |
| 4 - Dust container | 10 - Dual right/left dust inlet | 15 - Electric motor |
| 5 - Fuse | 11 - Ergonomic handles | 16 - Sound-proofed motor chamber |
| 6 - 120V Power supply | | |

INSTALLATION ALLOWANCES

STUDIO TS1	mm.
A	143
B	400
C	-
D	280
E	270
F	314
G	-
H	650
I	103
L	-
M	470
Q	floor level
P (recommended allowance)	1500
On side drawings of central general reference	

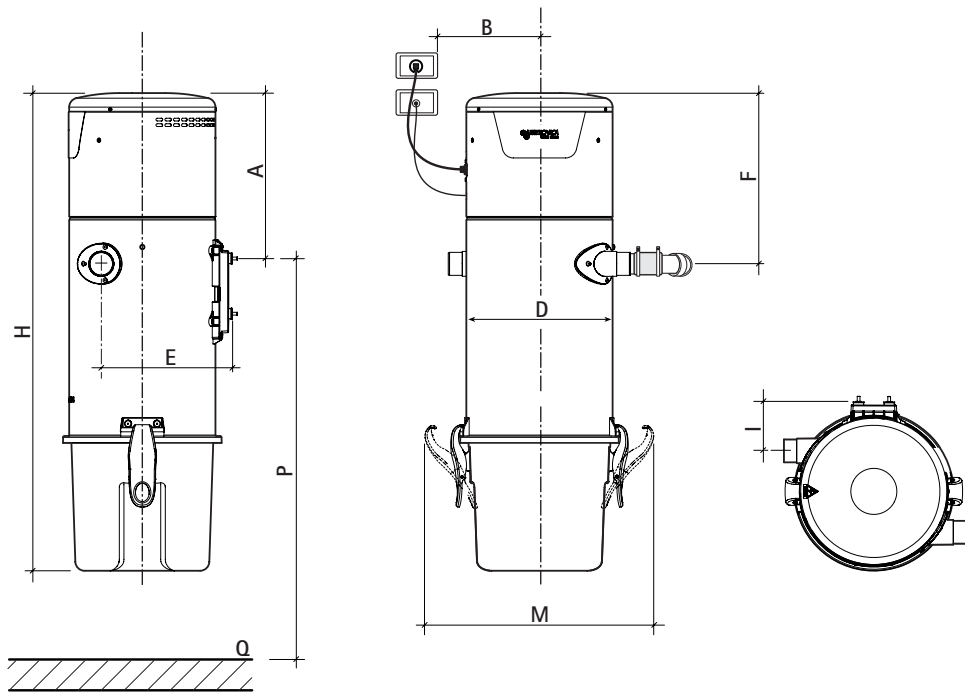

INSTALLATION PLAN

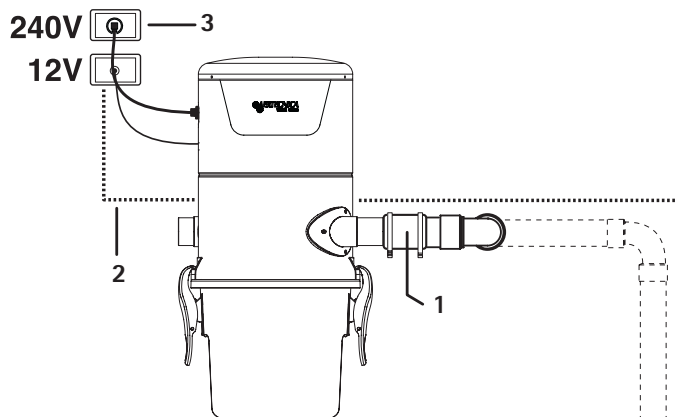

EXAMPLE OF INSTALLATION

- 1 - dust inlet line
- 2 - 12V socket line
- 3 - 240V power supply domestic line
- 4 - socket frames

